

Double and Triple Multiblock-Connectors

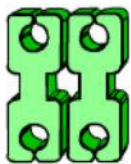

Double Multiblock

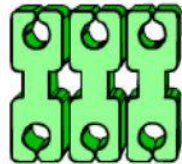

Triple Multiblock

These multiblock-connectors allow many exciting activities involving movement / animation using the built in hinging action. The extra holes allow mechanisms to be added easily

Cutting blocks off a strip:

Snips with serrated blades are the best tools to use. Sharp scissors are fairly good.

TIP

Make it a habit to trim the hinge part when you cut the blocks off the strip.

Ways of Using the Multiblock Hinged Connectors

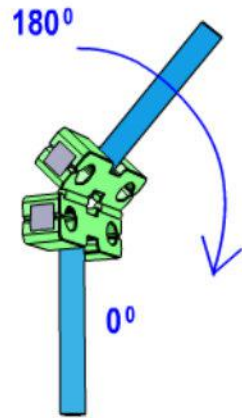

Two hinged multiblocks with two slit-rods

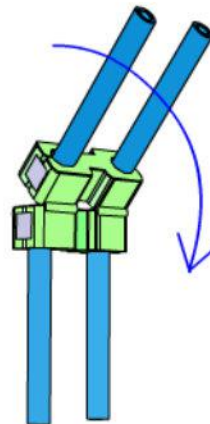

Two hinged multiblocks with parallel slit-rods

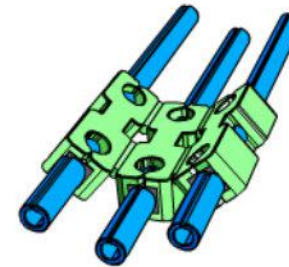

Three multiblocks hinged to make a cradle shape

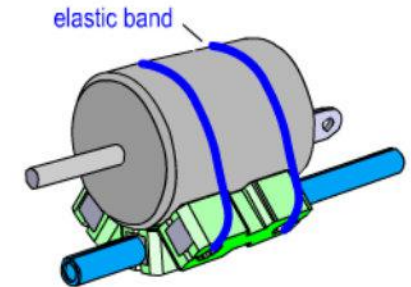

Make a cradle shape to hold electric motors etc - The elastic band holds it in place - (loop elastic through the slits)

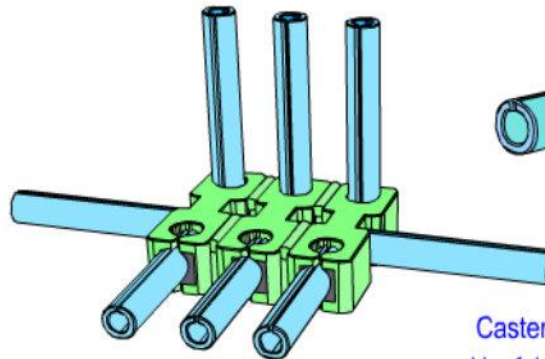

The slit-rod passing through the centre makes this shape rigid.

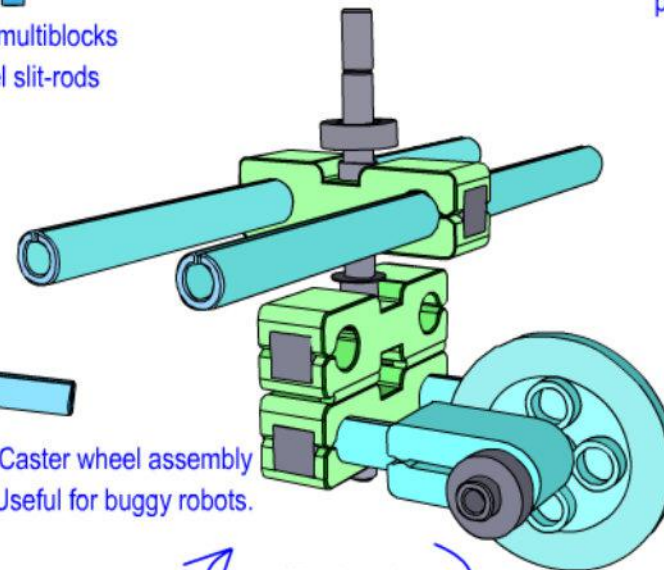

Caster wheel assembly
Useful for buggy robots.

Wheel rotation

Note - See 'Caster Wheel' web page for more details

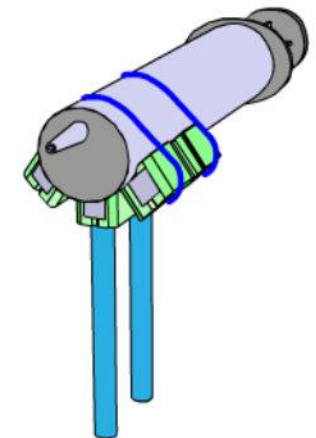

Cradle shape used to hold a syringe - used for pneumatic control work